

# Water Sensitive Urban Design Strategies



**PORT STEPHENS**  
COUNCIL

council@portstephens.nsw.gov.au | 02 4988 0255  
**PORTSTEPHENS.NSW.GOV.AU**    

# Corlette | Vantage Estate

## Name of WSUD Strategy:

Proposed Bagnalls Beach Basin No. 3 and Lorikeet Reserve Drainage Modifications for Landcom's Vantage Estate, Corlette

## Council Reference Number:

17/199622

A Water Sensitive Urban Design Strategy (WSUD Strategy) has been approved by Council for the purposes of clause 4.5 of the Port Stephens Development Control Plan 2014 for land in Corlette on the following streets:

- Mulubinda Parade
- Mooring Avenue
- Charthouse Avenue
- Spinaker Way
- Ebbside Way
- Tacking Street
- Bowline Circuit
- Dockside Avenue
- Reveal Cove
- Manung Terrace
- Nandu Boulevard
- Gawul Circuit
- Wirray Lane
- Duran Street
- Wulung Street
- Guyang Street
- Girambin Street
- Burrugi Street

## Construction Requirements:

- Stormwater Quality Improvement Devices are not required for developments that do not result in more than 60% impervious surface site coverage.
- For developments resulting in more than 60% impervious surface site coverage, a stormwater quality improvement device is required which meets Table BF of the Port Stephens Development Control Plan 2014.

## Catchment map

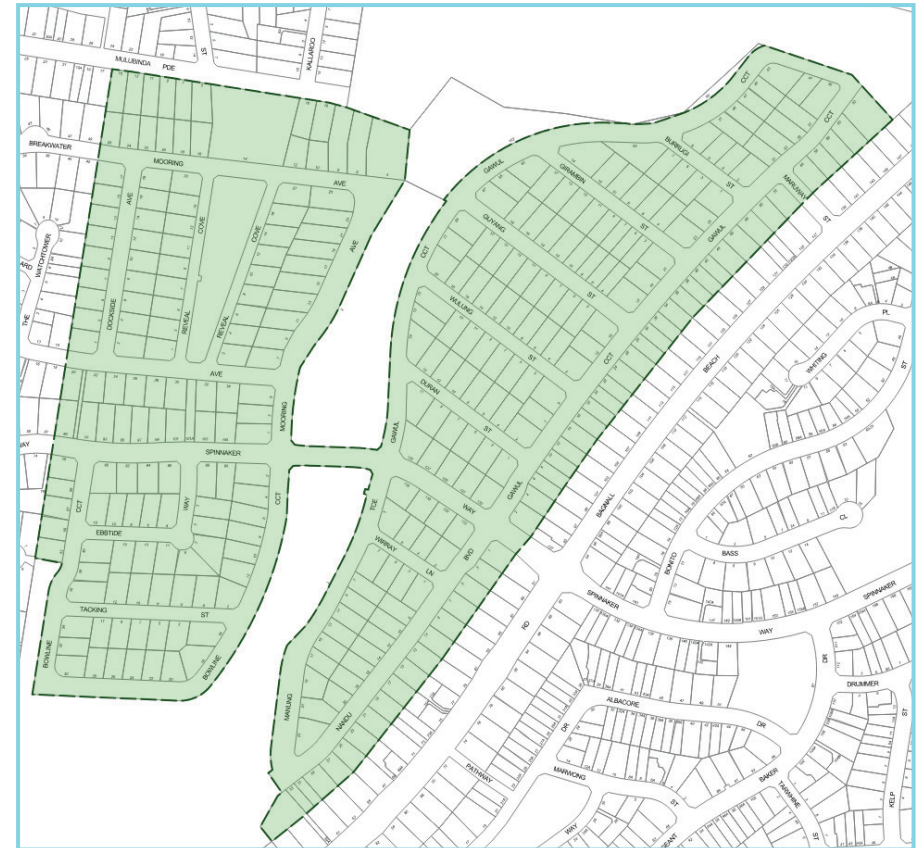

# Fern Bay | Seaside Village

## Name of WSUD Strategy:

Supplementary Water Cycle Management Information, Fern Bay, Seaside Village NSW

## Council Reference Number:

16/300740

A Water Sensitive Urban Design Strategy (WSUD Strategy) has been approved by Council for the purposes of clause 4.5 of the Port Stephens Development Control Plan 2014 for land in Fern Bay on the following streets:

- Seaside Boulevard
- Piper Street
- Spinifex Street
- Bora Street
- Bitou Way
- Tooroong Road
- Midden Road
- Wingen Street
- Ironbark Drive
- Paperbark Court
- Stringybark Drive
- Monkerai Street
- Rushland Drive
- Myrtle Street
- Sheoak Street
- Oimara Street
- Windsurf Circuit
- Tuckeroo Circuit
- Norfolk Street
- Fin Street
- Uralla Street
- Foxtail Street
- Rosemary Street
- Apple Street
- Sandcastle Street
- Dune Drive
- Providence Ave
- Grove Street
- Diuris Street
- Water Street
- Groundsel Street
- Plover Street
- Sygna Street
- Munmora Avenue
- Jabiru Drive
- Glider Avenue

## Construction Requirements:

- Stormwater Quality Improvement Devices are not required for developments that do not result in more than 60% impervious surface site coverage.
- For developments resulting in more than 60% impervious surface site coverage, a stormwater quality improvement device is required which meets Table BF of the Port Stephens Development Control Plan 2014.

## Catchment map

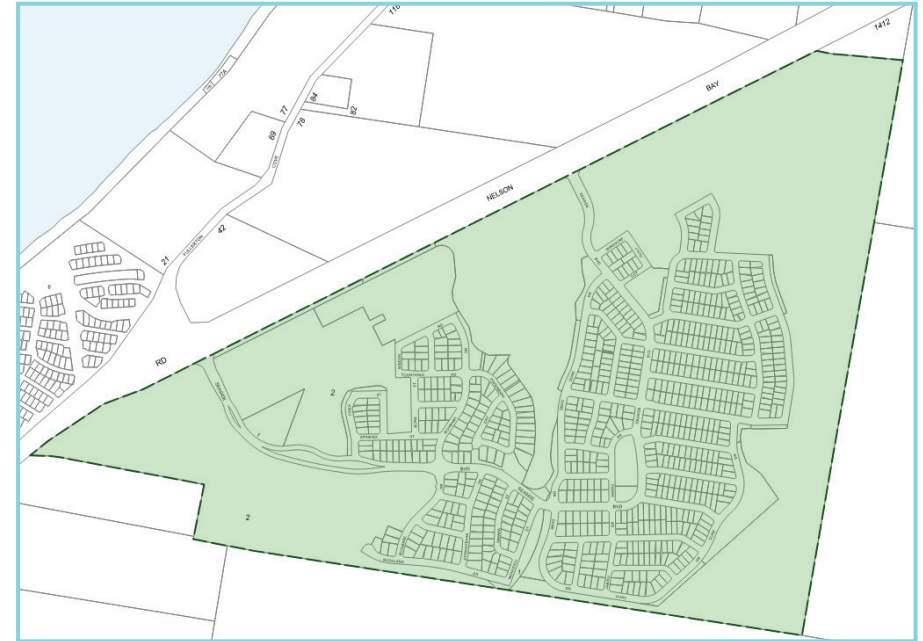

# Fullerton Cove | The Cove

## Name of WSUD Strategy:

Greenleaf by the Cove  
Stormwater Management  
Amendment to DA  
(Revised March 2007)

## Council Reference Number:

16/447649

A Water Sensitive Urban Design Strategy (WSUD Strategy) has been approved by Council for the purposes of clause 4.5 of the Port Stephens Development Control Plan 2014 for land in Fullerton Cove on the following streets:

- The Cove Drive
- Wagtail Way
- Whipling Way
- Bellbird Court
- Cockatoo Court
- Oriole Place
- Brushtail Place
- Ringtail Place
- Heron Circuit
- Sugar Glider Way
- Lorikeet Circuit

## Construction Requirements:

- For lots less than 900m<sup>2</sup>: Stormwater Quality Improvement Devices are not required for developments that do not result in more than 60% impervious surface site coverage.
- For lots less than 900m<sup>2</sup> that exceed 60% impervious surface site coverage and for lots that exceed 900m<sup>2</sup>: A stormwater quality improvement device is required which meets Table BF of the Port Stephens Development Control Plan 2014.

## Catchment map



# Heatherbrae | Kinross Business Park

## Name of WSUD Strategy:

Kinross Business Park

Stage 1 – Stormwater Management Code

&

Kinross Business Park Stages 2-16:

Stormwater Management Code

## Council Reference Number:

18/78912 (Stage 1) & 18/253387 (Stage 2-16)

A Water Sensitive Urban Design Strategy (WSUD Strategy) has been approved by Council for the purposes of clause 4.5 of the Port Stephens Development Control Plan 2014 for land in Heatherbrae on the following streets:

- Camfield Drive
- Whealan Close
- Ivory Close
- TBC (Road 3)
- TBC (Road 5)
- TBC (Road 6)
- TBC (Road 7)
- TBC (Road 8)
- TBC (Road 9)
- TBC (Road 10)

## Construction Requirements:

- Stormwater Quality Improvement Devices are not required for developments that do not result in more than 60% impervious surface site coverage.
- For developments resulting in more than 60% impervious surface site coverage, a stormwater quality improvement device is required which meets Table BF of the Port Stephens Development Control Plan 2014.

## Catchment map





# Karuah I River Oak Estate

## Name of WSUD Strategy:

Stormwater Quality Management Strategy

## Council Reference Number:

17/154315

A Water Sensitive Urban Design Strategy (WSUD Strategy) has been approved by Council for the purposes of clause 4.5 of the Port Stephens Development Control Plan 2014 for land in Karuah on the following streets:

- Holdom Road
- Monrante Road
- Sawyers Lane

## Additional information:

- Does not include the E2 environmental protection zone with Lot 200 SP 1247048.

## Construction Requirements:

- Stormwater Quality Improvement Devices are not required for developments that do not result in more than 60% impervious surface site coverage.
- For developments resulting in more than 60% impervious surface site coverage, a stormwater quality improvement device is required which meets Table BF of the Port Stephens Development Control Plan 2014.

## Catchment map



# Medowie | Bridle Ridge Estate

**Name of WSUD Strategy:**  
Water Quality Investigation

**Council Reference Number:**  
18/207639

A Water Sensitive Urban Design Strategy (WSUD Strategy) has been approved by Council for the purposes of clause 4.5 of the Port Stephens Development Control Plan 2014 for land in Medowie on the following streets:

- Wade Close
- Harvest Road
- Waterview Close

**Construction Requirements:**

- Stormwater Quality Improvement Devices are not required for developments that do not result in more than 60% impervious surface site coverage.
- For developments resulting in more than 60% impervious surface site coverage, a stormwater quality improvement device is required which meets Table BF of the Port Stephens Development Control Plan 2014.

Catchment map

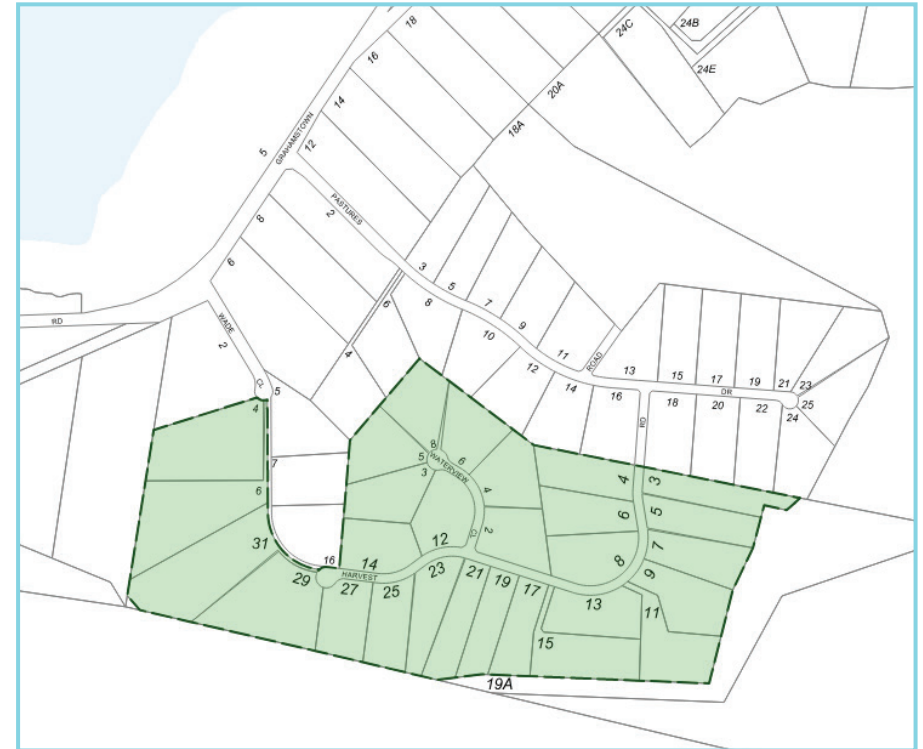



# Medowie | The Bower

## Name of WSUD Strategy:

Proposed Subdivision

Boundary Road Medowie

Stormwater Drainage Strategy

## Council Reference Number:

15/201038

A Water Sensitive Urban Design Strategy (WSUD Strategy) has been approved by Council for the purposes of clause 4.5 of the Port Stephens Development Control Plan 2014 for land in Medowie on the following streets:

- Boundary Road
- Western Road
- Bower Road
- Carolina Road
- Maya Drive
- Royal Avenue
- Liberty Road
- Topaz Avenue
- Miami Close
- TBC (Road 5)
- TBC (Road 6)
- TBC (Road 7)
- TBC (Road 10)

## Construction Requirements:

- Stormwater Quality Improvement Devices are not required for developments that do not result in more than 60% impervious surface site coverage.
- For developments resulting in more than 60% impervious surface site coverage, a stormwater quality improvement device is required which meets Table BF of the Port Stephens Development Control Plan 2014.

## Catchment map



# Medowie | Pacific Dunes

## Name of WSUD Strategy:

Stormwater Management Plan  
Port Stephens Golf & Country Club  
Pacific Dunes: Golf Resort

## Council Reference Number:

17/203621

A Water Sensitive Urban Design Strategy (WSUD Strategy) has been approved by Council for the purposes of clause 4.5 of the Port Stephens Development Control Plan 2014 for land in Medowie on the following streets:

- Sunningdale Circuit
- Carnoustie Way
- Kapalua Crescent
- Oakmont Avenue
- South Street
- Lakewood Drive
- Pinehurst Way
- St Andrews Parkway
- Huntingdale Place
- Muirfield Way
- Augusta Place
- Championship Drive
- Portmarnock Close
- Turnberry Lane

## Construction Requirements:

- Stormwater Quality Improvement Devices are not required for developments that do not result in more than 60% impervious surface site coverage.
- For developments resulting in more than 60% impervious surface site coverage, a stormwater quality improvement device is required which meets Table BF of the Port Stephens Development Control Plan 2014.

## Catchment map

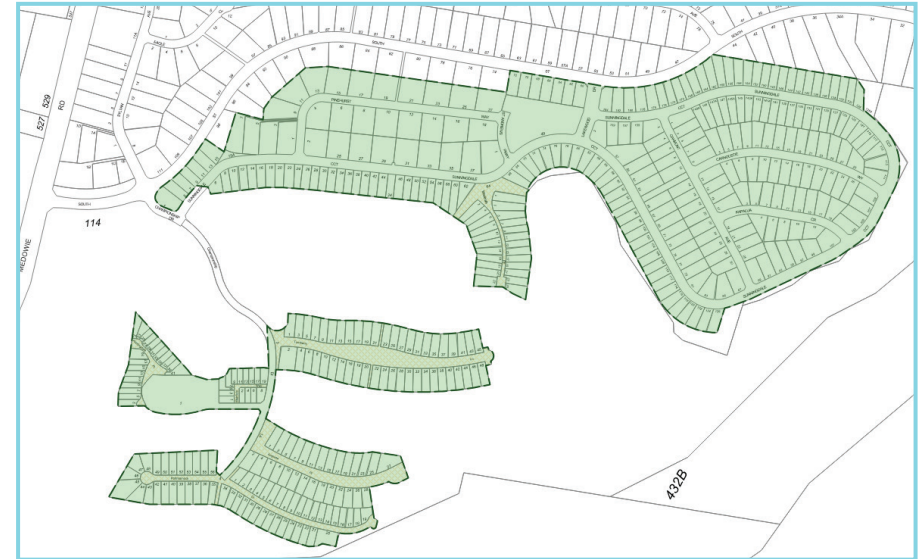

# One Mile | Seagrass Estate

## Name of WSUD Strategy:

Unknown

## Council Reference Number:

Unknown

A Water Sensitive Urban Design Strategy (WSUD Strategy) has been approved by Council for the purposes of clause 4.5 of the Port Stephens Development Control Plan 2014 for land in One Mile on the following streets:

- Seamist Avenue
- Saltbush Avenue
- Samurai Grove

## Additional information:

- Drains to wetland and into the Anna Bay Drainage Union drainage system.
- Water discharged via the piped outlet will make its way into the Anna Bay Drainage Union drainage system. And as such all properties draining into this system shall comply with the requirements of the union.

## Construction Requirements:

- Stormwater Quality Improvement Devices are not required for developments that do not exceed the maximum impervious surface area, in accordance with Port Stephens Development Control Plan Figure BD and Figure BE.
- For developments resulting in more than 60% impervious surface site coverage, a stormwater quality improvement device is required which meets Table BF of the Port Stephens Development Control Plan 2014.

## Catchment map



# Raymond Terrace | Maxus Valley Estate

**Name of WSUD Strategy:**  
Stormwater Management Plan

**Council Reference Number:**  
18/243576

A Water Sensitive Urban Design Strategy (WSUD Strategy) has been approved by Council for the purposes of clause 4.5 of the Port Stephens Development Control Plan 2014 for land in Raymond Terrace on the following streets:

- Kuranga Avenue
- TBC (Road 1)

**Construction Requirements:**

- Stormwater Quality Improvement Devices are not required for developments that do not result in more than 60% impervious surface site coverage.
- For developments resulting in more than 60% impervious surface site coverage, a stormwater quality improvement device is required which meets Table BF of the Port Stephens Development Control Plan 2014.

Catchment map

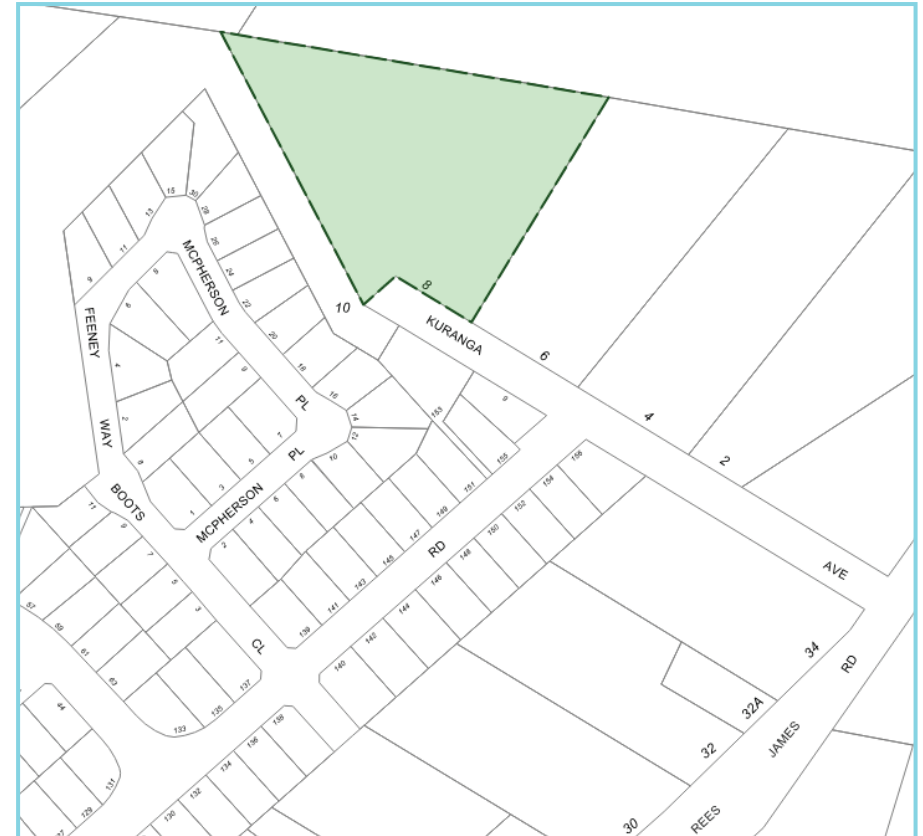

# Raymond Terrace | Potters Lane

## Name of WSUD Strategy:

Rees James Road Subdivision, Raymond Terrace Water Quality Management Strategy

## Council Reference Number:

13/1039/057

A Water Sensitive Urban Design Strategy (WSUD Strategy) has been approved by Council for the purposes of clause 4.5 of the Port Stephens Development Control Plan 2014 for land in Raymond Terrace on the following streets:

- Harold Road
- Dairyman Drive
- Sullivan Street
- Milkhouse Drive
- Graziers Parade
- Rosie Road
- Bailey Avenue
- Sailors Way
- Kuranga Avenue
- Buttercup Lane
- Herdsman Lane
- Fatches Road

## Construction Requirements:

- Stormwater Quality Improvement Devices are not required for developments that do not result in more than 60% impervious surface site coverage.
- For developments resulting in more than 60% impervious surface site coverage, a stormwater quality improvement device is required which meets Table BF of the Port Stephens Development Control Plan 2014.

## Catchment map





# Raymond Terrace | 161 Richardson Road

**Name of WSUD Strategy:**  
Stormwater Management Plan

**Council Reference Number:**  
17/226368

A Water Sensitive Urban Design Strategy (WSUD Strategy) has been approved by Council for the purposes of clause 4.5 of the Port Stephens Development Control Plan 2014 for land in Raymond Terrace on the following streets:

- Lakeview Crescent
- Baluster Street

**Construction Requirements:**

- Stormwater Quality Improvement Devices are not required for developments that do not result in more than 60% impervious surface site coverage.
- For developments resulting in more than 60% impervious surface site coverage, a stormwater quality improvement device is required which meets Table BF of the Port Stephens Development Control Plan 2014.

Catchment map

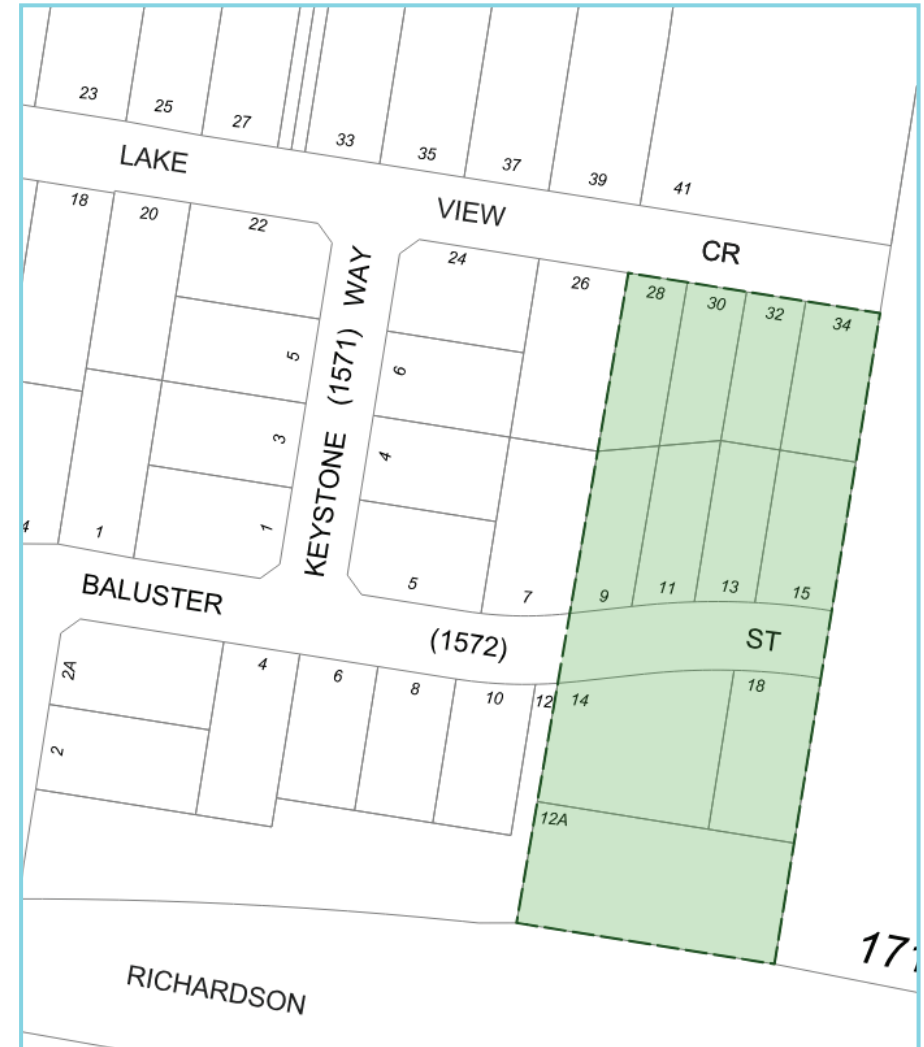

# Raymond Terrace | Roslyn Estate

Name of WSUD Strategy:

[MUSIC Model]

Council Reference Number:

16/364271

A Water Sensitive Urban Design Strategy (WSUD Strategy) has been approved by Council for the purposes of clause 4.5 of the Port Stephens Development Control Plan 2014 for land in Raymond Terrace on the following streets:

- Henning Road
- Binn Street
- Bridle Close

Construction Requirements:

- Stormwater Quality Improvement Devices are not required for developments that do not result in more than 60% impervious surface site coverage.
- For developments resulting in more than 60% impervious surface site coverage, a stormwater quality improvement device is required which meets Table BF of the Port Stephens Development Control Plan 2014.

Catchment map

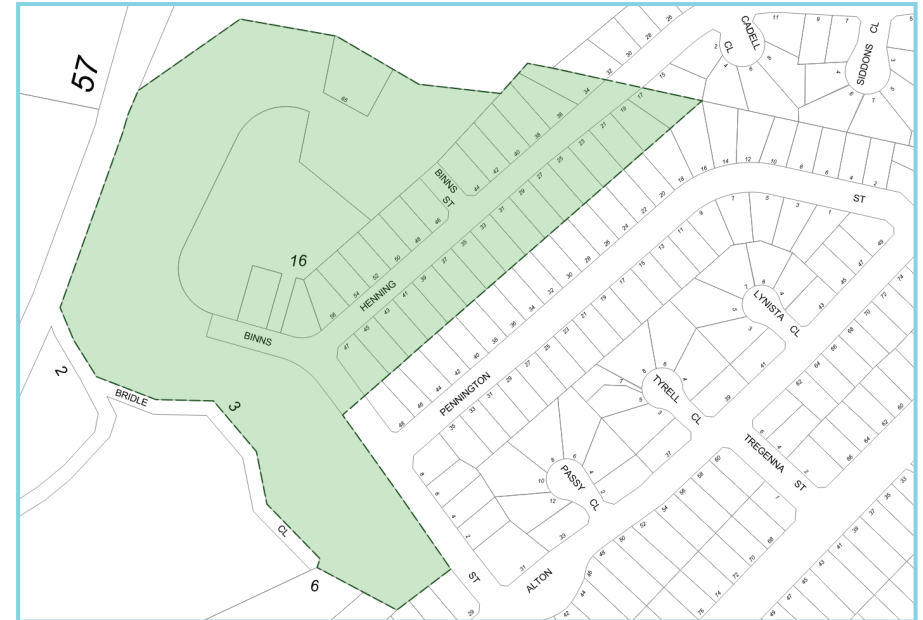



# Tanilba Bay | Koala Bay Estate

## Name of WSUD Strategy:

Proposed Drainage Strategy for Landcom Development Site off Lemon Tree Passage Road - Tanilba Bay

## Council Reference Number:

17/231332

A Water Sensitive Urban Design Strategy (WSUD Strategy) has been approved by Council for the purposes of clause 4.5 of the Port Stephens Development Control Plan 2014 for land in Tanilba Bay on the following streets:

- Pershing Place
- Yallimbah Avenue
- Broughton Circuit
- Reliance Boulevard
- Nepean Way
- Estramina Way
- Response Drive

## Construction Requirements:

- Stormwater Quality Improvement Devices are not required for developments that do not result in more than 60% impervious surface site coverage.
- For developments resulting in more than 60% impervious surface site coverage, a stormwater quality improvement device is required which meets Table BF of the Port Stephens Development Control Plan 2014.

## Catchment map

